

FTC 1 Series



Features

- Low Current Rating
- Upto 30 A
- Metal case
- Central screw fixing
- Compact dimensions
- High insertion loss
- Light Weight
- Easy to install
- High contact reliability

Technical Specification

- Rated voltage VR: 250 VAC/ 600 VDC
- Rated Current: 0.5A - 30A
- Capacitance: 0.1 μ F to 1 μ F
- Output Connection: Threaded studs/ Axial leads
- Input Connection: Threaded studs/ Axial leads
- Approvals: CSA Approved
- Capacitance tolerance: \pm 20%
- Temperature Range :-25 °C to 65 °C



Application

- Broadband interference suppression for AC/DC supply lines
- Shielded rooms
- Telephone exchanges, base stations
- Electrical machines and systems
- Power supplies

Presentation

Brass With Nickel Plating

Mounting

Feed Through Mounting

Termination

- Threaded studs
- Axial leads

Weight

200 Grams

HOW TO ORDER

EMIS-V-WWW-XXX-YYY-ZZZ
 V- C,L,Pi, WWW: Type(FT1, FT2, FT3)
 XXX: Current Rating, YYY: Voltage Rating
 ZZZ: Capacitance/Inductance

FTC-1

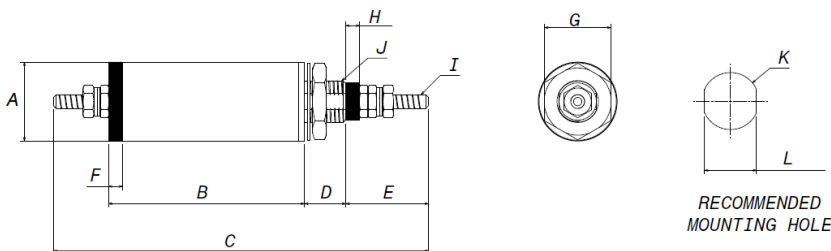

CURRENT RATING : 0.5A - 30A		
ZONE	0.1 μ F	0.22 μ F - 1 μ F
A	28.5 \pm 0.5	28.5 \pm 0.5
B	42.5 \pm 0.5	82 \pm 0.5
C	110 \pm 0.5	136 \pm 0.5
D	15 \pm 0.3	15 \pm 0.3
E	30 \pm 0.5	25 \pm 0.5
F	5 \pm 0.2	5 \pm 0.2
G	24 \pm 0.3	24 \pm 0.3
H	6 \pm 0.2	6 \pm 0.2
I	M3 = UPTO 10A	
	M4 = UPTO 20A	
	M5 = UPTO 30A	
J	M15x1.5	M15X1.5
K	ϕ 15.4	ϕ 15.4
L	14.5	14.5

** For Customised filter Contact our sales department